

LUBRICATING SYSTEM

	Page
LUBRICATING SYSTEM CIRCUIT	6-2
OIL PUMP	
DISASSEMBLY	6-4
INSPECTION	6-6
ASSEMBLY	6-7

LUBRICATING SYSTEM CIRCUIT

16R, 18R ENGINE

Fig. 6-1

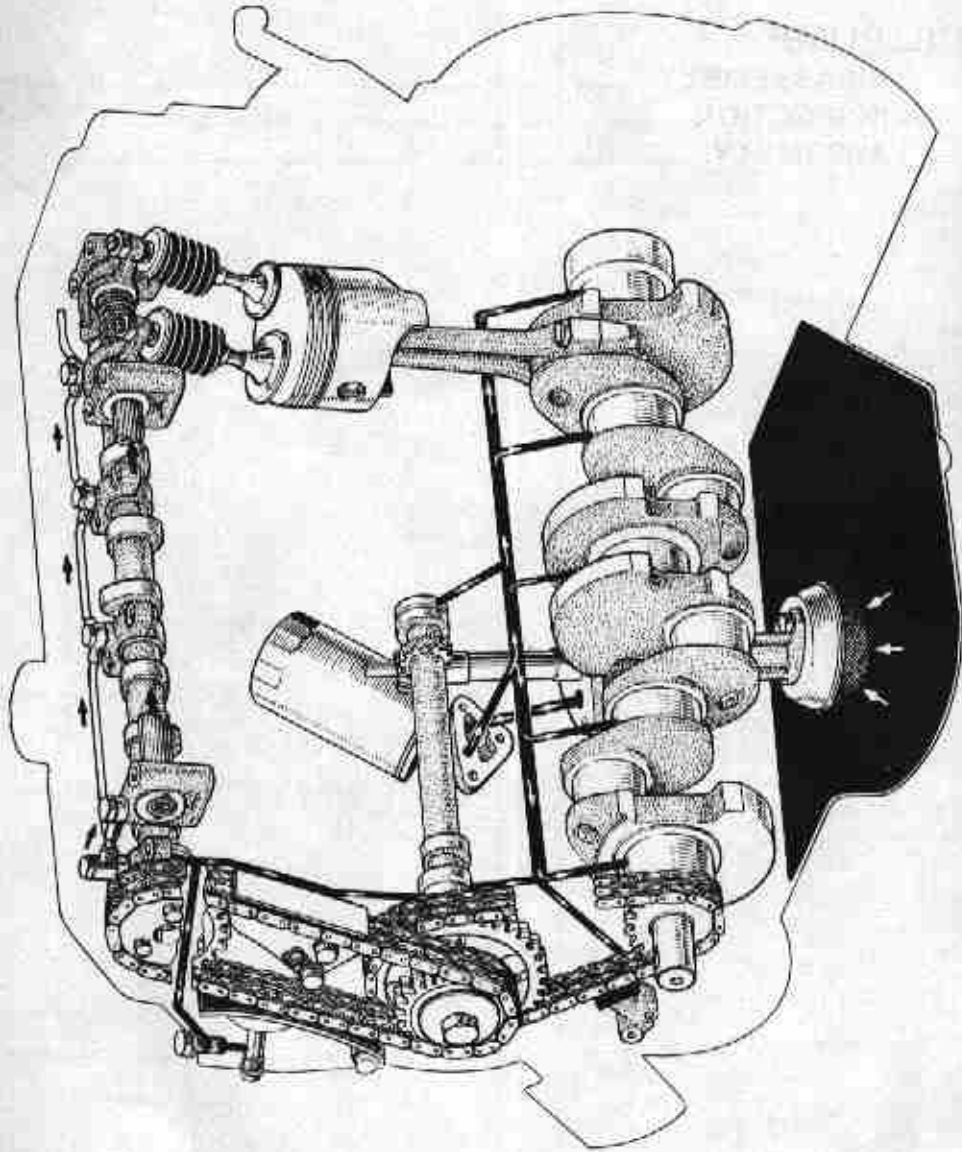

OIL PUMP**DISASSEMBLY (FOR 16R, 18R ENGINE)**

Disassemble in numerical order.

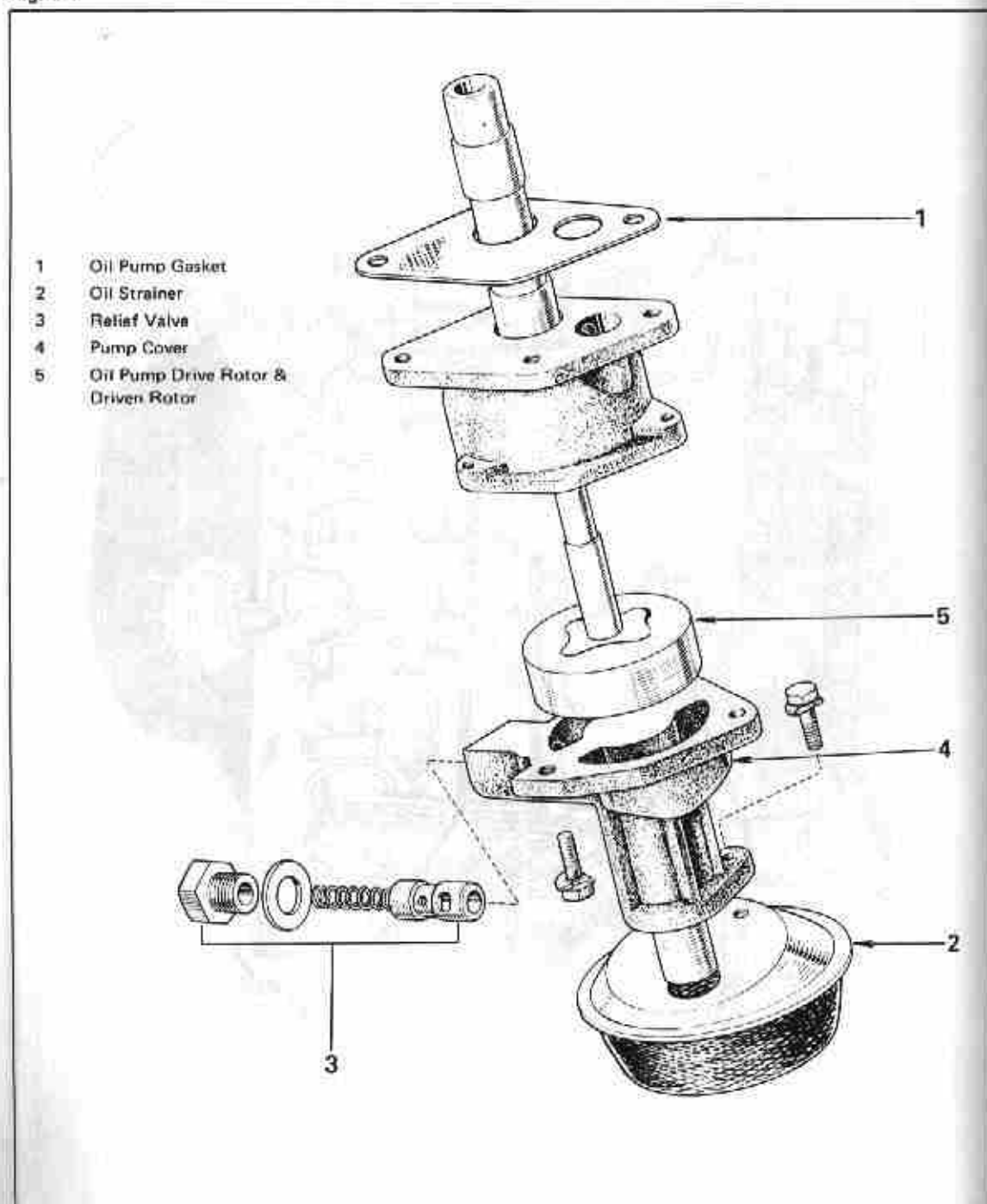
Fig. 6-3

DISAS

Disassemb

Fig. 6-4

1
2
3
4
5
6

DISASSEMBLY (FOR 18R-G ENGINE)

Disassemble in numerical order.

Fig. 6-4

- 1 Oil Pump Gasket
- 2 Oil Strainer
- 3 Relief Valve
- 4 Pump Cover
- 5 Oil Pump Drive Rotor & Driven Rotor
- 6 Oil Pump Body Spacer

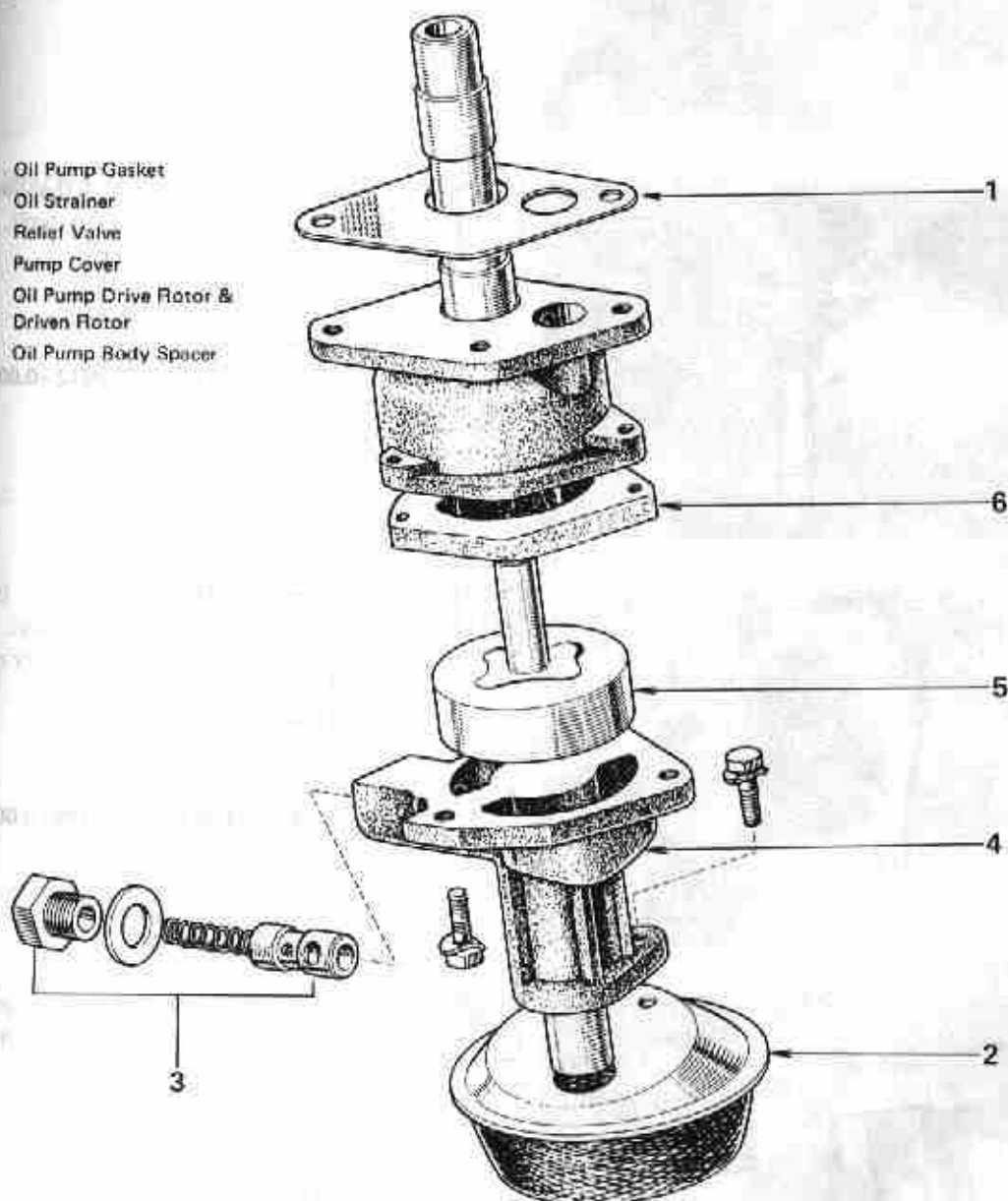

Fig. 6-5



Fig. 6-6

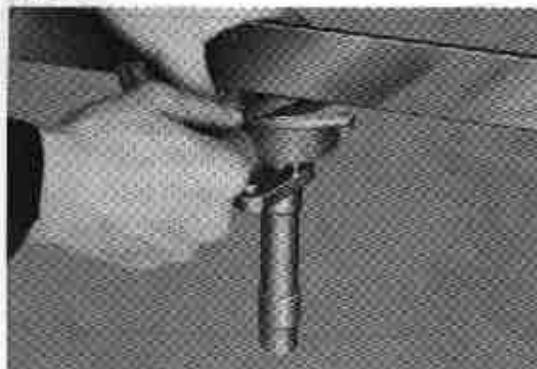
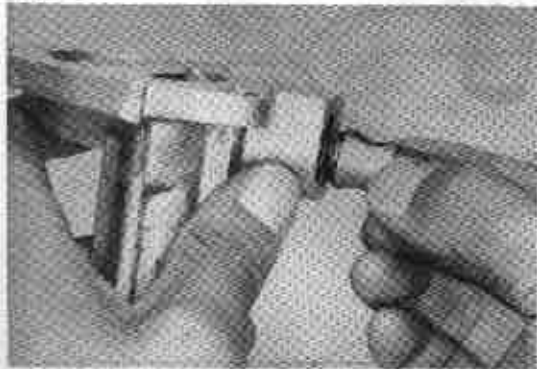

Fig. 6-7



Fig. 6-8



INSPECTION



1. Measure the tip clearance. If it exceeds limit, replace the oil pump drive rotor.

Limit

0.2 mm (0.008 in)

Standard

0.10–0.15 mm (0.0039–0.0059 in)



2. Measure the side clearance (between rotor and cover). If it exceeds limit, replace either rotor or pump body.

Limit

0.15 mm (0.0059 in)

Standard

0.03–0.07 mm (0.0012–0.0028 in)



3. Measure the body clearance (between driven rotor and pump body). If it exceeds limit, replace either rotor or pump body.

Limit

0.2 mm (0.008 in)

Standard

0.10–0.16 mm (0.0039–0.0063 in)



4. Inspect relief valve for scoring and wear. If damaged, replace valve or pump assembly.

ASSEMBLY

Assembly

Fig. 6-9

1
2
3
4
5

ASSEMBLY (FOR 16R, 18R ENGINE)

Assemble in numerical order.

Fig. 6-9

- 1 Oil Pump Drive Rotor & Driven Rotor
- 2 Pump Cover
- 3 Relief Valve
- 4 Oil Strainer
- 5 Oil Pump Gasket

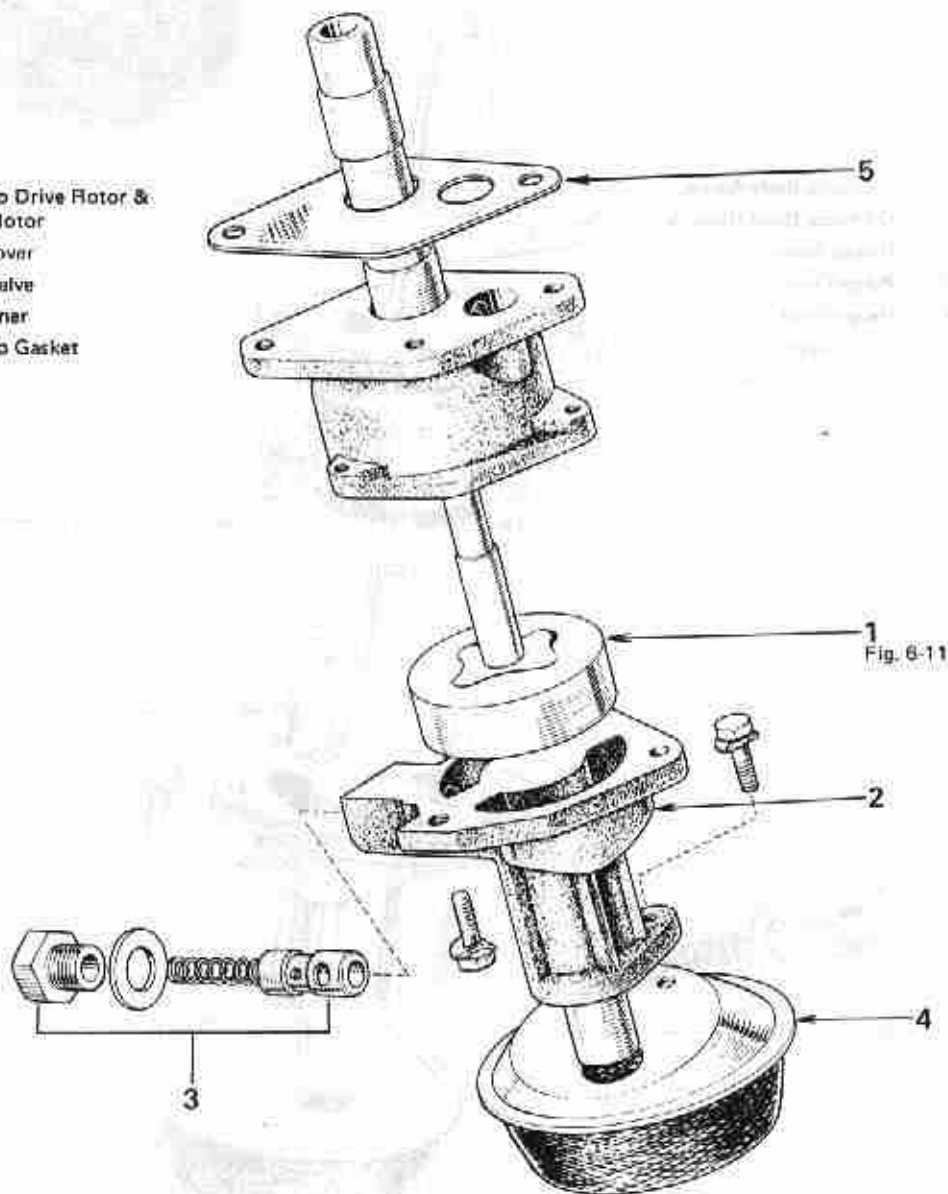

ASSEMBLY (FOR 18R-G ENGINE)

Assemble in numerical order.

Fig. 6-10

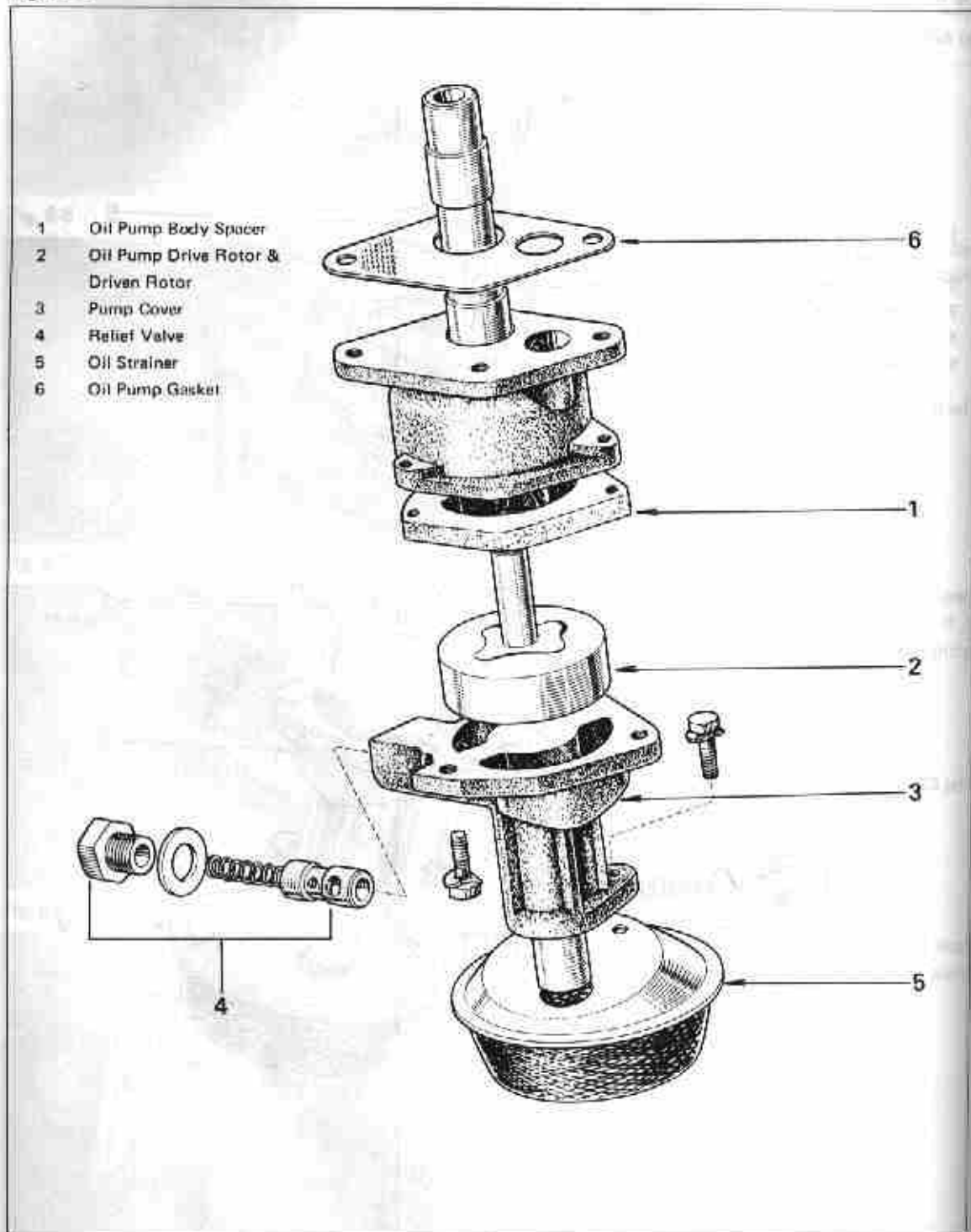

Fig. 6-11

**Check pump operation**

Immerse the suction end of the pump into clean engine oil and turn the shaft clockwise with a screwdriver. Oil should come out of the discharge hole. Close off the discharge hole with your thumb and turn the shaft as before. The shaft should be difficult to turn.